

# CHOCOLATE PLUS

## SOFTWARE INSTRUCTIONS

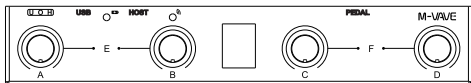

- **Website:** [www.m-vave.com](http://www.m-vave.com)
- **CubeSuite for Windows/Mac OS:** <http://www.m-vave.com/appdownload>
- **CubeSuite for Android/iOS:** scan the QR code

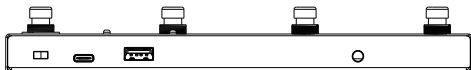

## Mode 1: Program Change A (PC Code)



Figure 1

## Mode 2: Program Change B (CC Code)



Figure 2

**Content:** PC codes from PC 0 to PC 127

**Switching Groups:** Use buttons E and F to switch groups

**Display:** The specific PC code will be shown on the display screen (Figure 1)

**Content:** CC codes from CC(0,0) to CC(127,0)

**Switching Groups:** Use buttons E and F to switch groups

**Display:** The specific CC code will be shown on the display screen (Figure 2)

## Mode 3: Custom Mode (CC Code)



Figure 3

**Content:** CC codes  
**MIDI Channel:** Can be selected

**Footswitch:** Clicking on the corresponding footswitch will send a toggle code. For example, for CC1, it can simultaneously send CC(1,1) and CC(1,0)(Figure 3)

## Mode 4: Advanced Custom Mode 1 (Various MIDI Codes)



Figure 4

**Content:** Five sub-modes with various types of MIDI codes

**MIDI Channel:** Can be selected

**Switching Groups:** Cannot switch banks using buttons E and F (Figure 4)

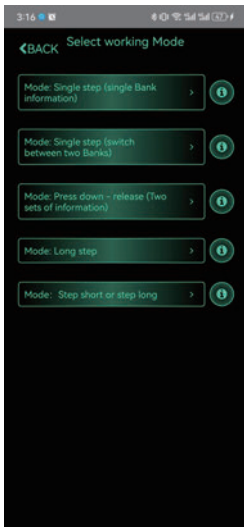

Figure 5

## Five Modes:

① Single Tap (Single Group of Information):Sends a corresponding MIDI code with each short tap. The same MIDI code is sent each time.

② Single Tap (Two Groups Switching):Sends two different MIDI codes alternately with each short tap. For example, the first tap sends PC1, the second tap sends PC2, and then it repeats.

③ Press-Release (Two Groups Switching):Sends two different MIDI codes with press and release actions. For example, pressing sends PC1, releasing sends PC2.

④Long Press:Sends a corresponding MIDI code with a long press. The same MIDI code is sent each time.

⑤ Short Tap-Long Press:Sends two different MIDI codes with a short tap and a long press. For example, a short tap sends PC1, and a long press sends PC2. This mode can be used to send toggle codes. (Figure 5)



Included MIDI Codes:PC codes, CC codes, NOTE ON and NOTE OFF codes, and SYSEX codes.(Figure 6)

Figure 6

## Mode 5: Advanced Custom Mode 2 (Various MIDI Codes)

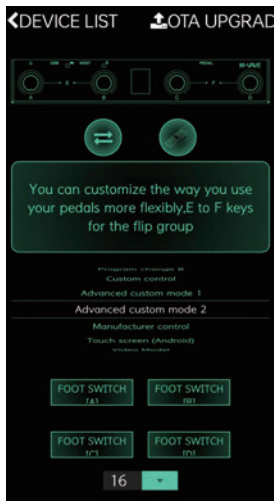

**Content:** Only short tap and long press modes

**MIDI Channel:** Can be selected.

**Switching Groups:** Can switch banks using buttons E and F (up to 16 groups can be selected in the software).

**Included MIDI Codes:** PC codes, CC codes, NOTE ON and NOTE OFF codes, and SYSEX codes.(Figure 7)

Figure 7

## Mode 6: Manufacturer Device Control Mode



**Content:** Internal mode for controlling M-VAVE brand products such as TANK-G, LOOPER PRO, and LOST TEMPO.(Figure 8)

Figure 8



## Mode 7: Touchscreen Mode



**Content:** The four footswitches correspond to:  
A: Swipe up  
B: Swipe down  
C: Swipe left  
D: Swipe right  
(Figure 9)



**Content:** The four footswitches correspond to:

- A: Rewind
- B: Fast forward
- C: Pause/Play
- D: Loop

Note: The loop function requires the Chrome browser and an extension. Currently supported websites: YouTube, Bilibili.

.(Figure 10)

Figure 10



**Content:** The four footswitches correspond to keyboard keys:

A: Up

B: Down

C: Left

D: Right

(Figure 11)

Figure 11



**Content:** The four footswitches correspond to keyboard keys:

A: Page Up

B: Page Down

C: Space

D: Enter

(Figure 12)

Figure 12

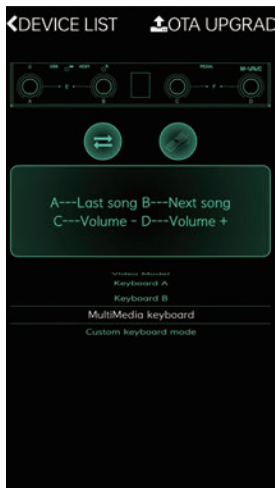

**Content:** The four footswitches correspond to multimedia keys:

A: Previous track

B: Next track

C: Volume down

D: Volume up

(Figure 13)

Figure 13

## Mode 12: Custom Keyboard Mode

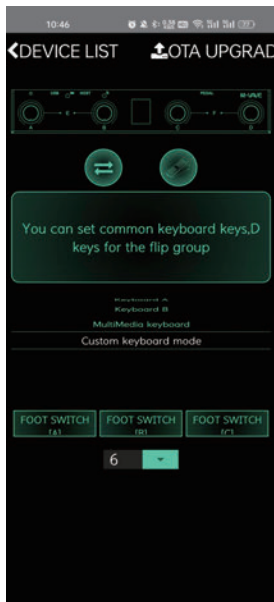

**Content:** Each footswitch can be set to a single key or a combination of keys. Banks can be switched using buttons E and F, with a total of 18 (groups of) keys. (Figure 14)

Figure 14

## Mode 12: Custom Keyboard Mode



Figure 15

### Combination Keys:

Combination Key 1 and Combination Key 2: Include Ctrl, Shift, Alt, and Win/Command. Note that Combination Key 1 and Combination Key 2 cannot use the same settings. Combination Key 3: Includes all other keys (letters A-Z, arrow keys, Page Up/Page Down, F1-F9).

**Example:** To set a combination key Ctrl+Shift+Z:  
Set Ctrl in Combination Key 1  
Set Shift in Combination Key 2  
Set Z in Combination Key 3  
This achieves the desired combination effect.  
(Figure 14)

# CHOCOLATE PLUS

## 软件使用说明

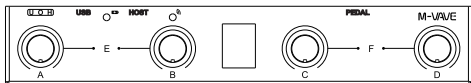

- **Website:** [www.m-vave.com](http://www.m-vave.com)
- **CubeSuite for Windows/Mac OS:** <http://www.m-vave.com/appdownload>
- **CubeSuite for Android/iOS:** scan the QR code





## 模式1:程序切换A (PC码)

■PC码从PC 0-PC 127, 通过E,F切换组, 在显示屏上会显示具体的PC码(如图1)



图1

## 模式2:程序切换B (CC码)

■CC码从CC(0,0)-CC(127,0), 通过E,F切换组, 在显示屏上会显示具体的CC码 (如图2)



图2

### 模式3:自定义模式 (CC码)



图3

■ CC码，可选择MIDI通道，点击到对应的踩钉里面有开关，可以发送一次开关码，例如以CC1为例，可以同时发送CC(1,1),CC(1,0)(如图3)

## 模式4:高级自定义模式1（多种MIDI码）



图4

■ 其中包含五种模式，各种形式的MIDI码，可以选择通道，不可通过E,F切换BANK（如图4）



图5

### 五种模式分别为:

①单踩（单组信息）：通过短踩发送一个对应的MIDI码，每次短踩发送的是同一个MIDI码

②单踩（两组切换）：通过短踩发送两组不同的MIDI码，以PC1和PC2举例，第一次短踩发送的是PC1，第二次短踩发送的是PC2，然后进行循环

③踩下-松开（两组切换）：通过踩下和松开触发踩钉发送两组不同的MIDI码，以PC1和PC2举例，踩下发送的是PC1，松开发送的是PC2

④长踩：通过长踩发送一个对应的MIDI码，每次长踩发送的是同一个MIDI码

⑤短踩-长踩：通过短踩和长踩发送两组不同的MIDI码，以PC1和PC2举例，短踩发送PC1，长踩发送PC2，这种模式可作为开关码发送（如图5）



图6

其中包含的MIDI码有PC码，CC码，NOTE ON和NOTE OFF码以及SYSEX码 SYSEX码（限定200字节）（如图6）

## 模式5:高级自定义模式2（多种MIDI码）



图7

其中只有短踩和长踩模式，各种形式的MIDI码，可以选择通道，可以通过E,F切换BANK，共16组，可以在软件上选择对应的组数

包含的MIDI码也同样为PC码，CC码，NOTE ON和NOTE OFF码以及SYSEX码 SYSEX码（限定200字节）（如图7）

## 模式6:厂商设备控制模式



图8

此模式为内部模式, 设置在这个模式的时候可以控制M-VAVE品牌产品, 其中包含TANK-G, LOOPER PRO, LOST TEMPO等产品 (如图8)

## 模式7:触摸屏模式



图9

对应四个踩钉为A-上滑, B-下滑, C-左滑, D-右滑 (如图9)

## 模式8:视频模式



图10

对应四个踩钉为A-快退, B-快进, C-暂停/播放, D-循环 (如图10)

注意: 循环功能需要使用 CHROME浏览器并安装扩展插件, 目前支持的网站为: YOUTUBE、BILIBILI

## 模式9:键盘模式A



图11

对应四个踩钉对应键盘的A-上, B-下, C-左, D-右 (如图11)

## 模式10:键盘模式B



图12

对应四个踩钉对应键盘的A-上一页，B-下一页，C-空格，D-回车（如图12）

## 模式11:多媒体按键模式



图13

每个踩钉可以设置一个单键或者组合键，可通过E,F切换BANK，一共为18个（组）按键。（如图13）



## 模式12：自定义键盘模式



图14



图15

每个踩钉可以设置一个单键或者组合键，可通过E,F切换BANK，一共为18个（组）按键。（如图14）

组合键1和组合键2中包含CTRL、SHIFT、ALT和WIN/COMMAND。

注意组合键1和组合键2不能使用相同的设置。  
组合键3中包含所有其他的键位（字母键A-Z、上下左右、页面翻页，F1-F9）。

例如我们要设置一个组合键 CTRL+SHIFT+Z就可以在组合键1设置CTRL，组合键2设置SHIFT，组合键3设置Z，来达到这个组合效果。（如图15）



图16

可以保存整体的预设，例如你有多个效果器，可以保存高级自定义等模式中设置好的整套预设以供下次不需要进入重新设置，直接载入使用。（如图16）